

CORNER RESTORATION

CORNER: NE SEC. 31, TWP. 7 S., RANGE 28 E., W.M.

ORIGINAL SURVEY BY: Frank W. Campbell

CONTRACT NUMBER: 521

CONTRACT DATE: January 8, 1885

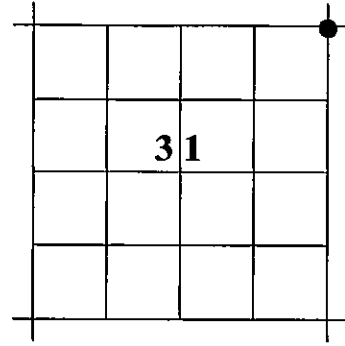

SUBSEQUENT SURVEYS:

- ▶ By Robert D. Bagett, Grant County Surveyor in 1995

ORIGINAL GLO DESCRIPTION: Set a basalt stone 14x10x4 ins., 9 ins. in the ground for cor. to Sec's. 29, 30, 31 & 32, marked with 1 notch on S. and 5 notches on E. edges and raised a mound of stone along side.

- ▶ 1995 BAGETT'S DESCRIPTION: Found a basalt stone 14x13x3 marked with 5 grooves on one face and 1 groove on an adjacent face, lying in a mound of stone. I accept this stone for the position of the section corner. It is harmoniously related to other known corners in this area. . . I set a 1½"x30" galv. iron pipe, 28" in the ground, with attached Grant County Surveyor brass cap marked as shown. From which I SCRIBE NEW BEARING TREES: A Juniper 6" diam., bears N25°E, 6.4 ft. marked T7SR28E S29 CSBT. A Juniper 8" diam., bears S72°E, 30.2 ft. marked T7SR28E S32 CSBT. A Juniper 13" diam., bears S17°W, 15.4 ft. marked T7SR28E S31 CSBT. A Juniper 7" diam., bears N60°W, 20.8 ft. marked T7SR28E S30 CSBT.

EVIDENCE FOUND AND NEW ACCESSORIES: Found the brass cap monument set by Bagett in 1995. The monument is in good condition in a 3 foot mound of stone. The cap is marked as shown below. We placed a fiberglass location post alongside the mound of stone.

A fire occurred in this area in the last couple of years, killing all four bearing trees. At the time of our visit, the bearing trees were still standing with remains of BT tags still attached.

FROM THE FOUND BRASS CAP MONUMENT, I SET THE FOLLOWING REFERENCE POINTS:

- ▶ A 5/8"x30" iron pin bears N.48°23'E., 17.84 feet with attached 1½" green plastic cap marked "GCS RP"
- ▶ A 5/8"x30" iron pin bears S.39°20'E., 28.40 feet with attached 1½" green plastic cap marked "GCS RP"
- ▶ A 5/8"x30" iron pin bears S.49°22'W., 35.46 feet with attached 1½" green plastic cap marked "GCS RP"
- ▶ A 5/8"x30" iron pin bears N.36°12'W., 15.71 feet with attached 1½" green plastic cap marked "GCS RP"

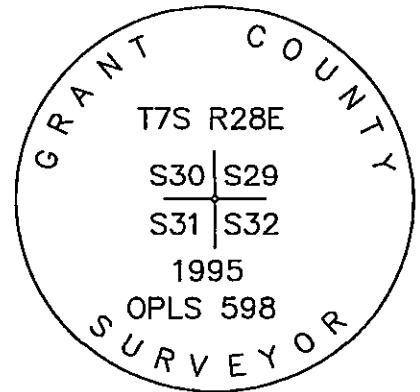

Used RTK GPS to measure the reference points.

STATE PLANE COORDINATES (3601 OR N)

Reference Datum: NAD83 From OPUS solution

Northing: 461,109.8 ft.
 Easting: 8,484,951.4 ft.
 Ellip. Ht: 2,721.4 ft.

RESTORATION BY, STAMP AND DATE:
 Michael C. Springer, PLS, Grant County Surveyor
 Jason L. Hatfield, PLS, Deputy County Surveyor

**RECEIVED AND FILED
 GRANT COUNTY SURVEYOR**

Surveyed November 16, 2012

NOV 16 2012
 BY:

